

Michaels®

Embroidery Design  
Sewing Information

# Production Worksheet

Wilcom TrueSizer



Design: **Succulents**

Title: **Succulents**

Stitches: 17,264  
 Height: 2.25 in  
 Width: 3.82 in  
 Colors: 8  
 Colorway: Colorway 1  
 Zoom: 1:1

Machine format: Tajima  
 Color changes: 8  
 Stops: 9  
 Trims: 119  
 Auto fabric: Custom Fabric  
 Required stabilizer: Topping:  
 Backing: Tear Away  
 x 2  
 Appliqués: 0  
 Left: 48.5 mm  
 Right: 48.5 mm  
 Up: 28.5 mm  
 Down: 28.5 mm  
 EndX: 0.00 in  
 EndY: 0.00 in  
 Area: 8.58 in<sup>2</sup>  
 Max stitch: 6.9 mm  
 Min stitch: 0.3 mm  
 Max jump: 6.9 mm  
 Total thread: 281.23ft  
 Total bobbin: 97.78ft

Stop Sequence:

#	#	Color	St.	Code	Name	Chart
1.	6		4,924	21	Wilcom	
2.	7		2,101	22	Wilcom	
3.	1		1,633	1	Wilcom	
4.	5		1,381	5	Wilcom	
5.	2		1,975	2	Wilcom	
6.	4		1,318	4	Wilcom	
7.	8		3,481	39	Wilcom	
8.	3		290	3	Wilcom	
9.	7		159	22	Wilcom	

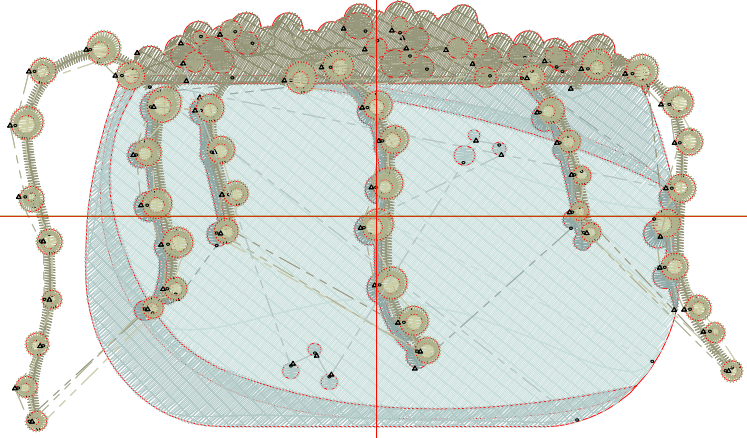

# Color Film

Wilcom TrueSizer



Design: **Succulents**

Title: **Succulents**

Stitches: 17,264  
Height: 2.25 in  
Width: 3.82 in  
Colors: 8  
Colorway: Colorway 1  
Zoom: 0.49

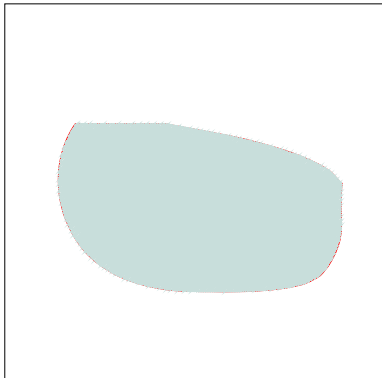

Stop #: 1  
Code: 21  
Name:  
Chart: Wilcom  
Stitches: 4,924  
Thread used: 110.13ft



Stop #: 2  
Code: 22  
Name:  
Chart: Wilcom  
Stitches: 2,101  
Thread used: 36.17ft

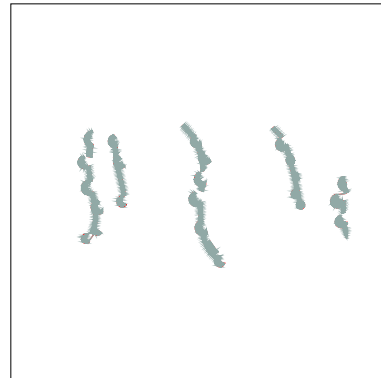

Stop #: 3  
Code: 1  
Name:  
Chart: Wilcom  
Stitches: 1,633  
Thread used: 20.44ft

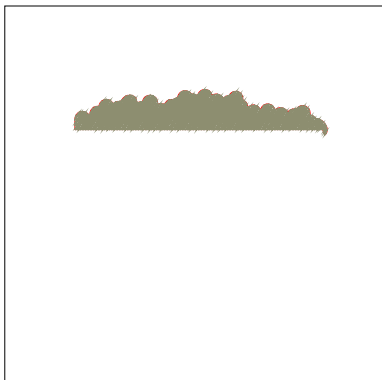

Stop #: 4  
Code: 5  
Name:  
Chart: Wilcom  
Stitches: 1,381  
Thread used: 24.18ft



Stop #: 5  
Code: 2  
Name:  
Chart: Wilcom  
Stitches: 1,975  
Thread used: 25.08ft

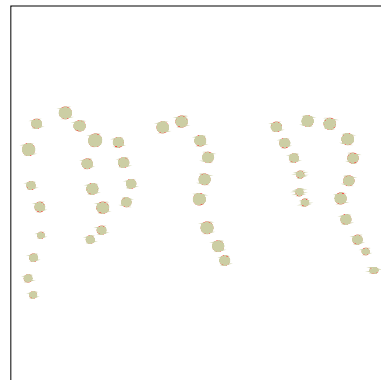

Stop #: 6  
Code: 4  
Name:  
Chart: Wilcom  
Stitches: 1,318  
Thread used: 18.22ft

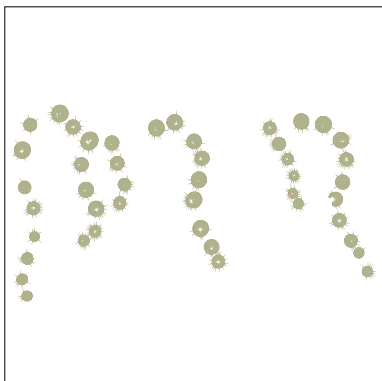

Stop #: 7  
Code: 39  
Name:  
Chart: Wilcom  
Stitches: 3,481  
Thread used: 38.23ft



Stop #: 8  
Code: 3  
Name:  
Chart: Wilcom  
Stitches: 290  
Thread used: 3.91ft

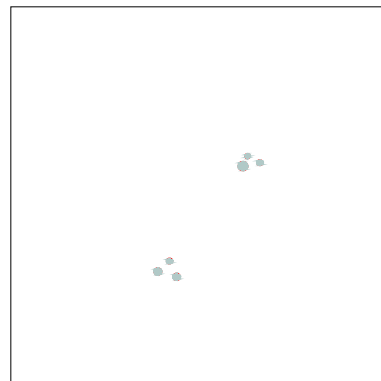

Stop #: 9  
Code: 22  
Name:  
Chart: Wilcom  
Stitches: 159  
Thread used: 1.92ft