

Michaels®

Embroidery Design  
Sewing Information

# Production Worksheet

Wilcom TrueSizer



Stitches: 10,618  
 Height: 3.80 in  
 Width: 3.42 in  
 Colors: 6  
 Colorway: Colorway 1  
 Zoom: 1:1

Design: **Metal Nautical Anchor with Ring Buoy**

Title: **Metal Nautical Anchor with Ring Buoy**

Machine format: Tajima  
 Color changes: 7  
 Stops: 8  
 Trims: 21  
 Auto fabric: Pure Cotton  
 Required stabilizer: Topping:  
 Backing: Tear Away  
 x 2  
 Appliqués: 0  
 Left: 43.4 mm  
 Right: 43.4 mm  
 Up: 48.3 mm  
 Down: 48.3 mm  
 EndX: 0.00 in  
 EndY: 0.00 in  
 Area: 13.01 in<sup>2</sup>  
 Max stitch: 9.6 mm  
 Min stitch: 0.3 mm  
 Max jump: 6.9 mm  
 Total thread: 193.69ft  
 Total bobbin: 71.93ft

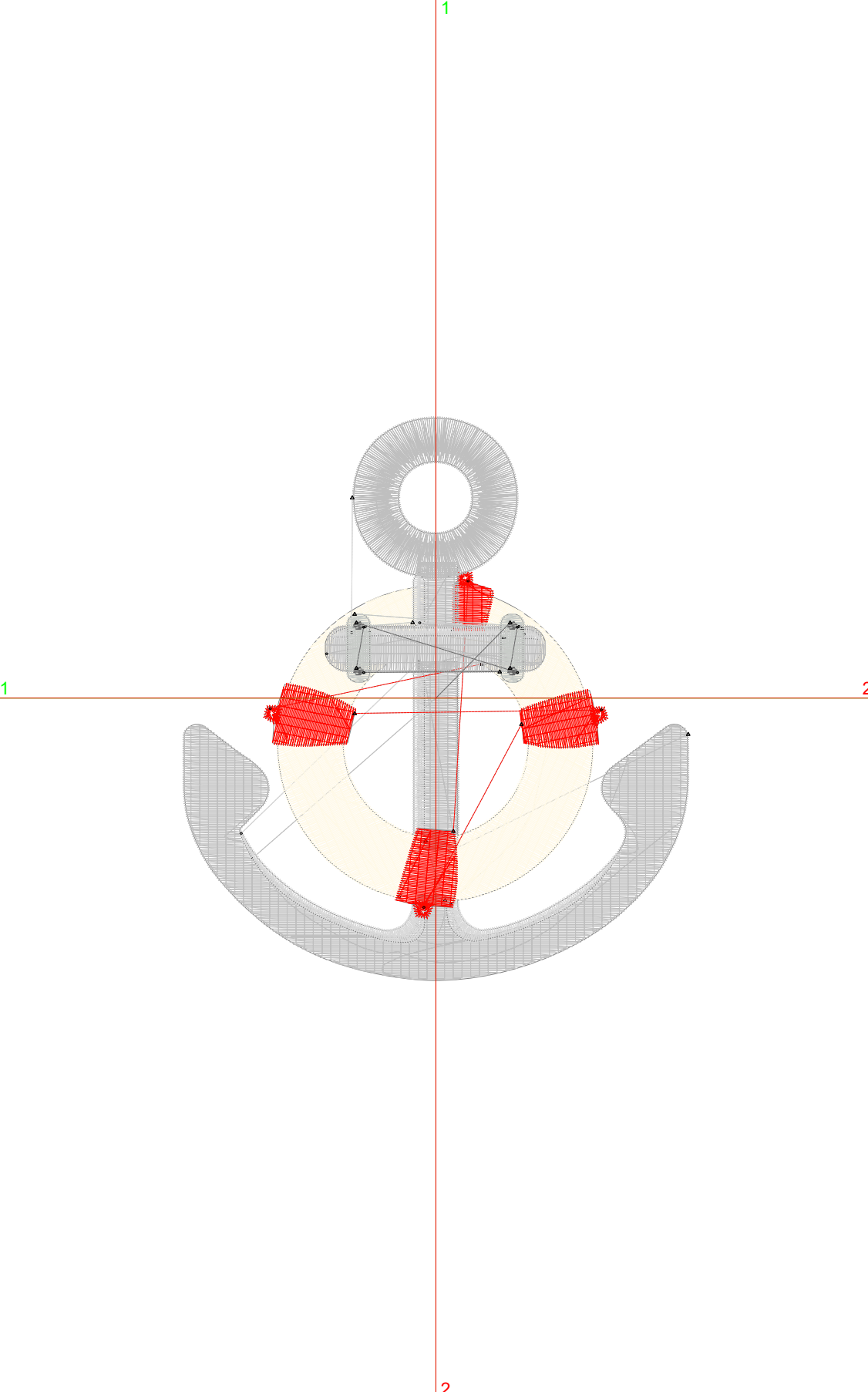

Stop Sequence:

#	#	Color	St.	Code	Name	Chart
1.	14	█	2,971	14	Wilcom	
2.	1	█	752	1	Wilcom	
3.	15	█	2,571	15	Wilcom	
4.	5	█	1,187	5	Wilcom	
5.	14	█	2,491	14	Wilcom	
6.	1	█	326	1	Wilcom	
7.	2	█	230	2	Wilcom	
8.	13	█	88	13	Wilcom	

**Color Film**

Wilcom TrueSizer



Stitches: 10,618  
Height: 3.80 in  
Width: 3.42 in  
Colors: 6  
Colorway: Colorway 1  
Zoom: 0.49

Design: **Metal Nautical Anchor with Ring Buoy**

Title: **Metal Nautical Anchor with Ring Buoy**

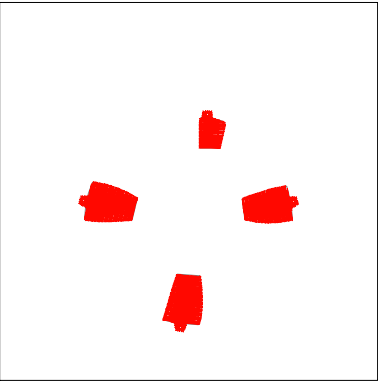
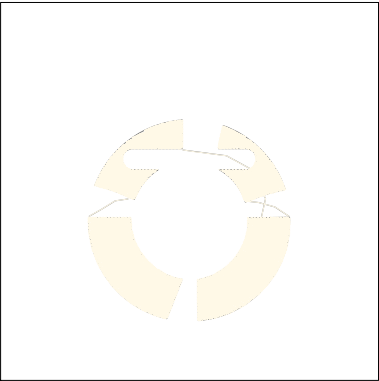
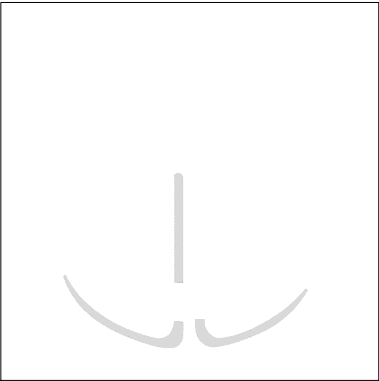
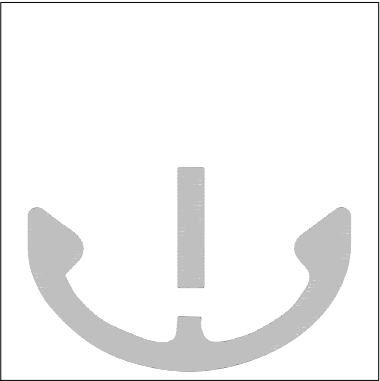

Stop #: 1  
Code: 14  
Name:  
Chart: Wilcom  
Stitches: 2,971  
Thread used: 57.06ft

Stop #: 2  
Code: 1  
Name:  
Chart: Wilcom  
Stitches: 752  
Thread used: 11.45ft

Stop #: 3  
Code: 15  
Name:  
Chart: Wilcom  
Stitches: 2,571  
Thread used: 47.66ft

Stop #: 4  
Code: 5  
Name:  
Chart: Wilcom  
Stitches: 1,187  
Thread used: 19.89ft

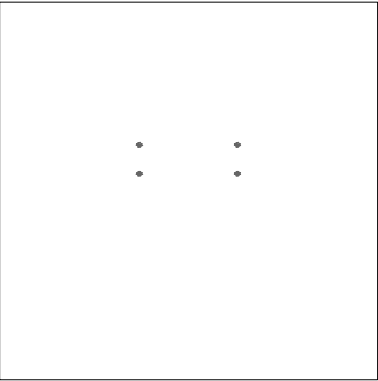
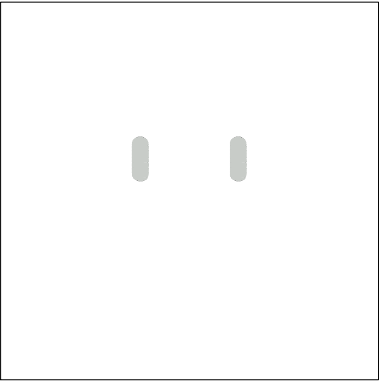
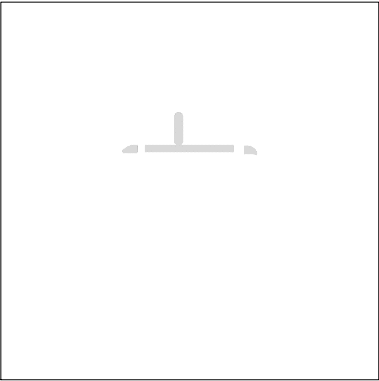
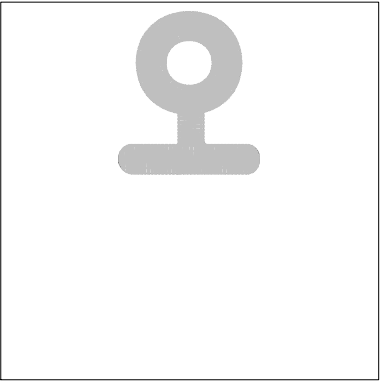

Stop #: 5  
Code: 14  
Name:  
Chart: Wilcom  
Stitches: 2,491  
Thread used: 45.04ft

Stop #: 6  
Code: 1  
Name:  
Chart: Wilcom  
Stitches: 326  
Thread used: 4.51ft

Stop #: 7  
Code: 2  
Name:  
Chart: Wilcom  
Stitches: 230  
Thread used: 4.51ft

Stop #: 8  
Code: 13  
Name:  
Chart: Wilcom  
Stitches: 88  
Thread used: 0.94ft