

Michaels[®]

**Embroidery Design
Sewing Information**

Production Worksheet

Wilcom TrueSizer



Design: **Archery Target**

Title: **Archery Target**

Stitches: 23,879
 Height: 3.82 in
 Width: 3.79 in
 Colors: 6
 Colorway: Colorway 1
 Zoom: 1:1

Machine format: Tajima
 Color changes: 8
 Stops: 9
 Trims: 13
 Auto fabric: Pure Cotton
 Required stabilizer: Topping:
 Backing: Tear Away
 x 2
 Appliqués: 0
 Left: 48.2 mm
 Right: 48.2 mm
 Up: 48.5 mm
 Down: 48.5 mm
 EndX: 0.00 in
 EndY: 0.00 in
 Area: 14.48 in²
 Max stitch: 6.9 mm
 Min stitch: 0.4 mm
 Max jump: 7.0 mm
 Total thread: 443.77ft
 Total bobbin: 168.37ft

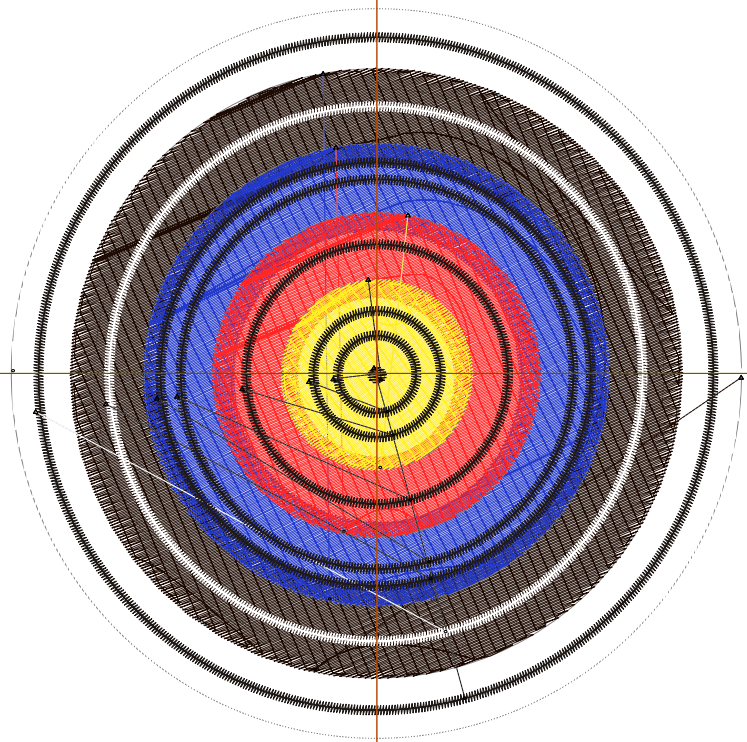

Stop Sequence:

#	#	Color	St.	Code	Name	Chart
1.	6	White	5,733	15	White	Wilcom
2.	7	Black	5,045	7		Wilcom
3.	1	Blue	3,509	2		Wilcom
4.	3	Red	2,220	5		Wilcom
5.	2	Yellow	961	4		Wilcom
6.	7	Black	28	7		Wilcom
7.	5	Black	1,700	13	Black	Wilcom
8.	6	White	1,354	15	White	Wilcom
9.	5	Black	3,327	13	Black	Wilcom

Color Film

Wilcom TrueSizer



Design: **Archery Target**

Title: **Archery Target**

Stitches: 23,879
Height: 3.82 in
Width: 3.79 in
Colors: 6
Colorway: Colorway 1
Zoom: 0.49

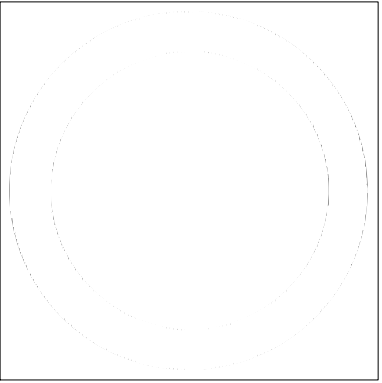

Stop #: 1
Code: 15
Name: White
Chart: Wilcom
Stitches: 5,733
Thread used: 117.89ft

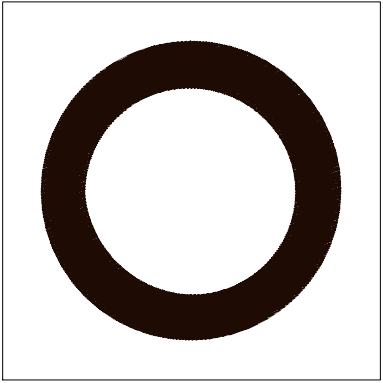

Stop #: 2
Code: 7
Name:
Chart: Wilcom
Stitches: 5,045
Thread used: 105.13ft

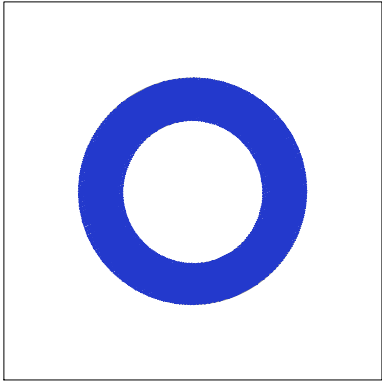

Stop #: 3
Code: 2
Name:
Chart: Wilcom
Stitches: 3,509
Thread used: 72.77ft

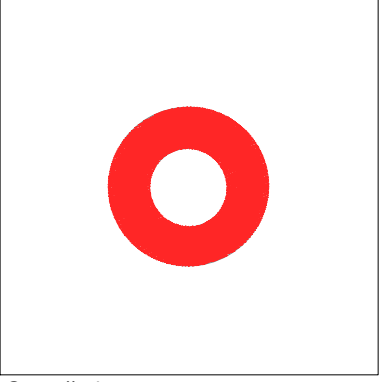

Stop #: 4
Code: 5
Name:
Chart: Wilcom
Stitches: 2,220
Thread used: 45.54ft

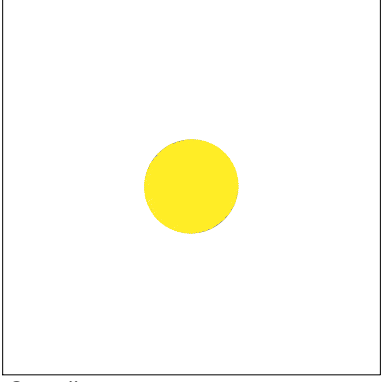

Stop #: 5
Code: 4
Name:
Chart: Wilcom
Stitches: 961
Thread used: 19.96ft

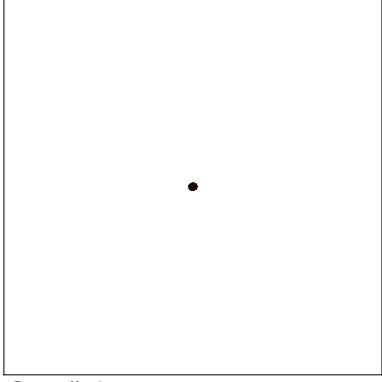

Stop #: 6
Code: 7
Name:
Chart: Wilcom
Stitches: 28
Thread used: 0.37ft

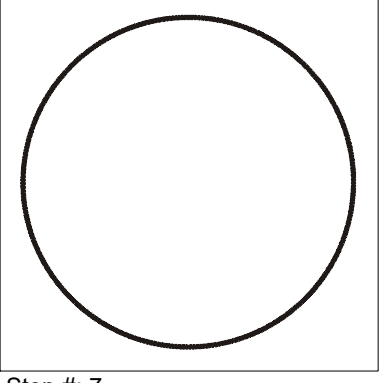

Stop #: 7
Code: 13
Name: Black
Chart: Wilcom
Stitches: 1,700
Thread used: 21.14ft

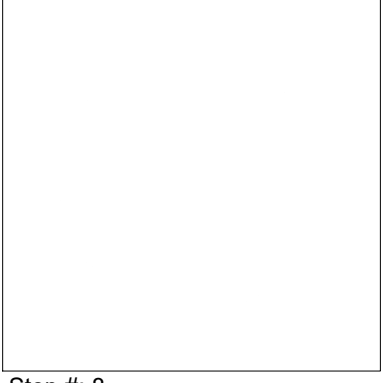

Stop #: 8
Code: 15
Name: White
Chart: Wilcom
Stitches: 1,354
Thread used: 16.82ft

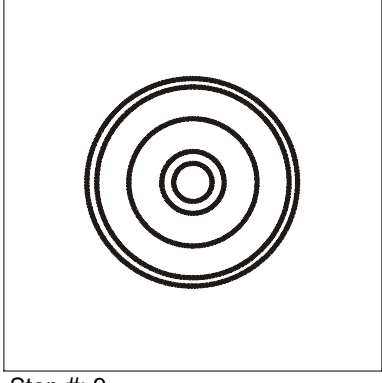

Stop #: 9
Code: 13
Name: Black
Chart: Wilcom
Stitches: 3,327
Thread used: 41.19ft